



Route Log Progress Chart

DRAFT

Please Note: Errors and Omissions May Exist.
Contact the VTrans Mapping Unit with questions or concerns.

DISTRICT	TOWN	ROUTE
	[u'1093-0000']	I-93

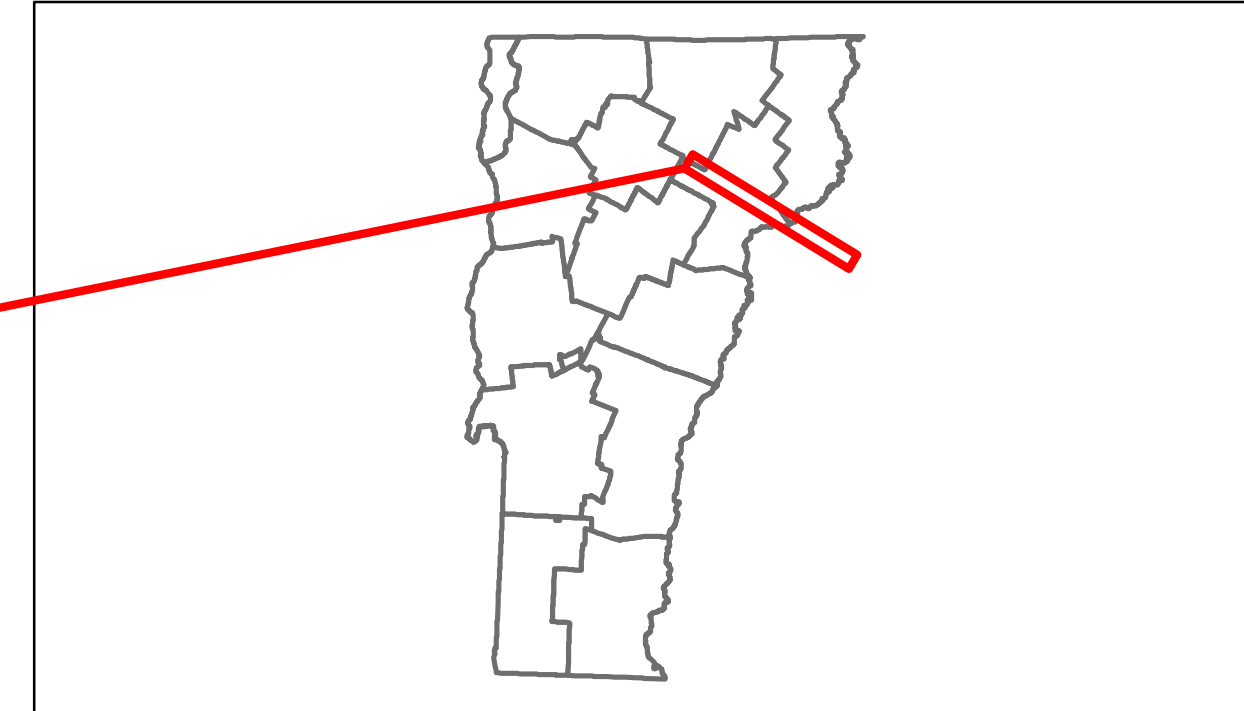

Base Map

1 in = 2 miles

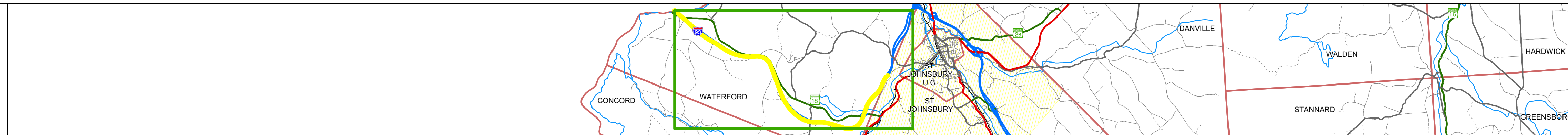

Stick Diagram

- Primary Structures
- Secondary Structures
- Stations (Feet)
- Railroad Crossings
- Divided State Highway
- State Highway
- Divided Class 1 Town Highway
- Class 1 Town Highway
- Town Boundary
- District Boundaries
- State/Town Highway Change
- Divided Highway Limits
- Ghost Section Boundary
- Streams

Scale: 1in = 2000 FEET

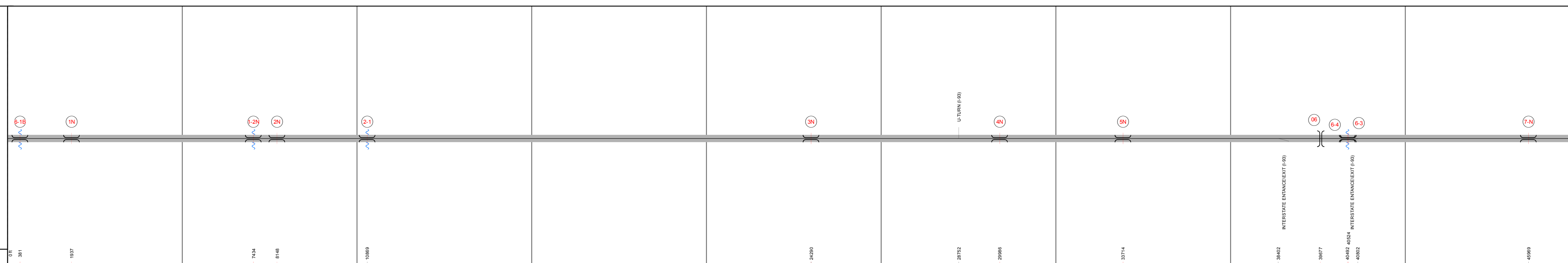

Road Widths

Travellane: 45' 34'

Roadway Lane Count: 4

Base: 24' Mix Base Course

Subbase: Crushed Gravel

0	1	2	3	4	5	6	7	8	9

Curves

--	--	--	--	--	--	--	--	--	--

Grades

--	--	--	--	--	--	--	--	--	--

Historic Projects

Maintenance Garage

--	--	--	--	--	--	--	--	--	--

Traffic Counters

--	--	--	--	--	--	--	--	--	--

Functional Class

--	--	--	--	--	--	--	--	--	--

Speed Zone

--	--	--	--	--	--	--	--	--	--

AADT Counts

2012									5900
2011									5900
2010									5900
2009									5700
2008									5400

Crash Locations

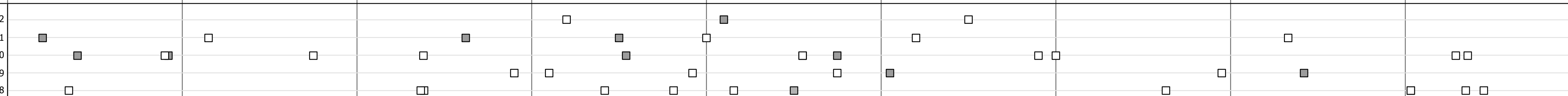

DESCRIPTION BLOCK

Culvert 0-1B:
Culvert - 1982
Structure No. 3000936-1B03161
Length: 14'
Under Clearance: 7.0'
Facility Carried: 193
Bridge Type: R C BOX
Features Intersected: STILES BROOK
Maintenance: State

Bridge 1N:
Frame - 1982
Structure No. 200093001N03162
Length: 205'
Width: 36.7'
Under Clearance: 16.75'
Facility Carried: I 00093 ML
Bridge Type: STEEL RIGID FRAME
Features Intersected: I 93 OVER VT 18
Surface: Bituminous
Maintenance/Ownership: State

Culvert 1-2N:
Culvert - 1982
Structure No. 3000931-2N03161
Length: 6'
Under Clearance: 6.0'
Facility Carried: 193
Bridge Type: ACCGMP
Features Intersected: BROOK
Maintenance: State

Culvert 2N:
Culvert - 1982
Structure No. 200093002N03162
Length: 28'
Under Clearance: 14.17'
Facility Carried: I 00093 ML
Bridge Type: CONCRETE BOX CULVERT
Features Intersected: I 93 OVER TH NO 17
Maintenance/Ownership: State

Culvert 2-1:
Culvert - 1982
Structure No. 30009302-103161
Length: 7'
Under Clearance: 7.0'
Facility Carried: 193
Bridge Type: CCMPP
Features Intersected: BROOK
Maintenance: State

Bridge 3N:
Stringer/multi-beam or girder - 1982
Structure No. 200093003N03162
Length: 113'
Width: 36.7'
Under Clearance: 15.17'
Facility Carried: I 00093 ML
Bridge Type: WELDED PLATE GIRDER
Features Intersected: I 93 OVER TH NO 12
Surface: Bituminous
Maintenance/Ownership: State

Culvert 4N:
Culvert - 1982
Structure No. 200093004N03162
Length: 28'
Under Clearance: 14.58'
Facility Carried: I 00093 ML
Bridge Type: CONCRETE BOX CULVERT
Features Intersected: I 93 OVER TH NO 1
Maintenance/Ownership: State

Bridge 5N:
Stringer/multi-beam or girder - 1982
Structure No. 200093005N03162
Length: 109'
Width: 36.7'
Under Clearance: 18.25'
Facility Carried: I 00093 ML
Bridge Type: WELDED PLATE GIRDER
Features Intersected: I 93 OVER TH NO 7
Surface: Bituminous
Maintenance/Ownership: State

Bridge 6:
Stringer/multi-beam or girder - 1982
Structure No. 20022500903162
Length: 214'
Height: 0.0'
Weight Limit: 0
Facility Carried: VT 00018 ML
Bridge Type: 2 SP CONT WLD PL GIR
Features Intersected: I 93 UNDER VT 18

Culvert 6-3:
Culvert - 1982
Structure No. 30009306-303161
Length: 9'
Under Clearance: 7.0'
Facility Carried: 193
Bridge Type: R C BOX
Features Intersected: WATER MAIN SLEEVE
Maintenance: State

Culvert 6-4:
Culvert - 1982
Structure No. 30009306-403161
Length: 14'
Under Clearance: 12.0'
Facility Carried: 193
Bridge Type: R C BOX
Features Intersected: LAND ACCESS ROAD
Maintenance: State

<p>Historic Projects</p> <ul style="list-style-type: none"> Retreatment Resurface Unknown Bituminous Mix Skimny Mix Bituminous Seal Gravel Surface Treated Gravel Plant Mix Reclaimed Base and Bituminous Concrete Concrete 	<p>Functional Class</p> <ul style="list-style-type: none"> 1 2 6 7 8 11 12 14 16 17 19 <p>Speed Zones</p> <p>25 30 35 40 45 50 55 60 65</p>	<p>Curves</p> <ul style="list-style-type: none"> curve left curve right 	<p>Road Widths</p> <p>(ft)</p>	<p>Traffic Counters</p> <p>(counter ID)</p>	<p>Crash Locations</p> <ul style="list-style-type: none"> Fatal Injury Property Damage Only Unknown Crash Type 	<p>Mileage by Functional Class By Sheet</p> <p>93-1 1 - Rural - Principal Arterial - Interstate 9.000</p>	<p>Mileage by Town By Sheet</p> <p>[u'1093-0000'] - 1093-0000 9.0 of 11.104</p>	<p>DISTRICT</p>	<p>TOWN</p> <p>[u'1093-0000']</p>	<p>Date: 11/14/13</p>	<p>ROUTE</p> <p>I-93</p> <p>ETE mileage: 0.0 to 11.104</p>
						<p>Total Mileage: 9.000 mi</p>		<p>Total Mileage: 9.0 mi</p>		<p>1 of 2</p> <p>TWN mileage: 0.0 to 9.0</p>	